

D.1.1.01 | UNDERGROUND FLOOR PLAN

SCALE 1:50, FAMILY HOUSE WITH TATTOO STUDIO

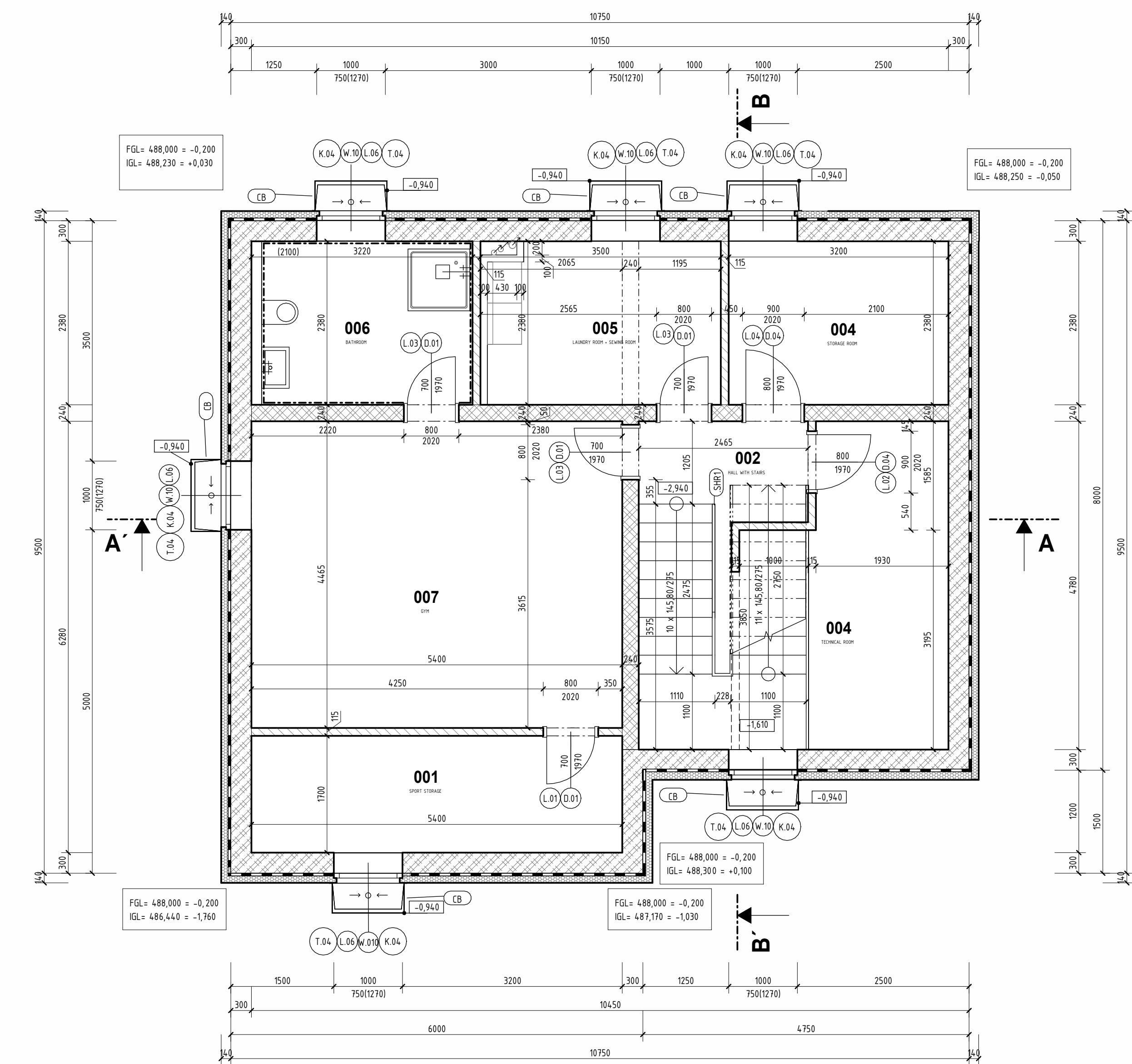

LEGEND

FLOOR	NUMBER	NAME	AREA [m2]	FINISHES		
				FLOORING FINISH	CEILING FINISH	WALL FINISH
1PP	001	SPORT STORAGE	9,18	CERAMIC FLOOR	BEST PANEL + ACRYLATE PAINT	LIME-CEMENT CORE PLASTER WITH STUCCO PLASTER
	002	HALL WITH STAIRS	8,09	CERAMIC FLOOR	BEST PANEL + ACRYLATE PAINT	LIME-CEMENT CORE PLASTER WITH STUCCO PLASTER
	004	TECHNICAL ROOM	12,79	CERAMIC FLOOR	BEST PANEL + ACRYLATE PAINT	LIME-CEMENT CORE PLASTER WITH STUCCO PLASTER
	004	STORAGE ROOM	7,62	CERAMIC FLOOR	BEST PANEL + ACRYLATE PAINT	LIME-CEMENT CORE PLASTER WITH STUCCO PLASTER
	005	LAUNDRY ROOM + SEWING ROOM	7,93	CERAMIC FLOOR	BEST PANEL + ACRYLATE PAINT	LIME-CEMENT CORE PLASTER WITH STUCCO PLASTER
	006	BATHROOM	7,31	CERAMIC FLOOR	BEST PANEL + ACRYLATE PAINT	CERAMIC TILES
	007	GYM	24,11	CERAMIC FLOOR	BEST PANEL + ACRYLATE PAINT	LIME-CEMENT CORE PLASTER WITH STUCCO PLASTER
			77,03			

LEGEND OF MATERIALS

- LOAD-BEARING MASONRY – CONCRETE PERMANENT FORMWORK BLOCKS 30 – SHAPE LOCKS, FILLED WITH C16/20 CONCRETE. BLOCKS MADE OF PLAIN VIBRO-PRESSED CONCRETE, APPROXIMATE CONCRETE CONSUMPTION: 0.19 m³/m² (0.63 m³/m³).
- LOAD-BEARING MASONRY – GROUND CERAMIC BLOCK, STRENGTH CLASS P15/P10, GROUND CLAY BLOCK FOR 240 mm WALL THICKNESS, LAID WITH THIN-LAYER MORTAR
- NON-LOAD-BEARING MASONRY – GROUND CERAMIC BLOCK, STRENGTH CLASS P10, GROUND CLAY BLOCK FOR 115 mm WALL THICKNESS, LAID WITH THIN-LAYER MORTAR
- THERMAL INSULATION MADE OF EXTRUDED POLYSTYRENE (XPS) WITH SMOOTH SURFACE, THICKNESS 140 mm, LAP JOINT, DECLARED THERMAL CONDUCTIVITY COEFFICIENT λD = 0.036 W·m⁻¹·K⁻¹, COMPRESSIVE STRENGTH AT 10% DEFORMATION σ10% = 300 kPa
- ORIGINAL SOIL
- PLAIN CONCRETE WITH GLASS FIBRE MAT – CLASS AND EXPOSURE ACCORDING TO THE STRUCTURAL LAYER COMPOSITION
- WATERPROOFING MADE OF SBS-MODIFIED BITUMEN MEMBRANES WITH REINFORCING LAYER ACCORDING TO LAYER COMPOSITION. THICKNESS ACCORDING TO LAYER COMPOSITION, FULLY BONDED OR TORCHED ONTO A PRIMED SURFACE

NOTES

- STRUCTURAL COMPOSITIONS SEE: STRUCTURAL COMPOSITION BOOK
- CONNECTION OF FOUNDATION STRIPS AND FORMWORK BLOCKS TO BASEMENT WALLS SEE: FOUNDATION PLAN
- THE FIRST ROW OF CERAMIC MASONRY SHALL BE BUILT FROM FOUNDATION BLOCKS H=300 MM ON A FOUNDATION MORTAR
- EXTERNAL BASE INSULATION IS DESIGNED FROM XPS TH. 140 MM AND WILL EXTEND UP TO A HEIGHT OF 300 MM ABOVE ±0.000
- ALL DIMENSIONS MUST BE VERIFIED ON SITE ACCORDING TO THE ACTUAL EXECUTION, DRAWINGS DO NOT SUBSTITUTE MANUFACTURING DOCUMENTATION!!
- DOOR AND WINDOW OPENINGS ARE DIMENSIONED BY STRUCTURAL OPENING SIZE
- SPECIAL ATTENTION MUST BE PAID TO DETAILING, ESPECIALLY CONNECTION OF THE LOWER BUILDING STRUCTURE AND CONNECTION OF WINDOW AND DOOR OPENINGS TO THE EXTERNAL WALL TO PREVENT THERMAL BRIDGES

REFERENCES TO ANNEXES

- Dxx

BOOK OF INTERIOR DOORS
- Txx

BOOK OF CARPENTRY PRODUCTS
- Wxx

BOOK OF WINDOWS AND EXTERIOR DOORS
- Kxx

BOOK OF SHEET METAL PRODUCTS
- Lxx

BOOK OF LINTELS

OTHER PRODUCTS

- SHR1

STAIRS HANDRAIL – WOODEN
- CB

PREFABRICATED CONCRETE LIGHT WELL – INTERNAL DIMENSIONS 1000 × 400 MM, HEIGHT 1600 MM, EDGES ADAPTED FOR GRATING TERMINATION

LIST OF LINTELS

SYMBOL	NAME OF LINTEL	DIMENSION	No. OF LINTELS PER 1 ASSEMBLY
L01	CERAMIC LINTEL KP11.5	1000x11.5x7.1	1
L02	CERAMIC LINTEL KP11.5	1250x11.5x7.1	1
L03	CERAMIC LINTEL KP11.5	1000x11.5x7.1	2
L04	CERAMIC LINTEL KP11.5	1250x11.5x7.1	2
L06	CERAMIC LINTEL KP7	1250x7x23.8	3

±0,000 = 488,3 m.a.s.l.,B.H.S
/ COORDINATE SYSTEM S-JTSK

COURSE	BACHELORS' THESIS		<div><div>T</div><div>FAST</div></div>	
DRAWN BY	ADELA MATUŠOVÁ			
SUPERVISED BY	PROF.ING.JITKA MOHELNÍKOVÁ, PH.D.			
INVESTOR	-			
LOCATION	Krokočín, č. p. 730/2 a 728/č, okres Třebíč, Kraj Vysočina			
PROJECT TITLE	FAMILY HOUSE WITH TATTOO STUDIO			
BUILDING OBJECT	SO 01		PAPER FORMAT	594x420 (A2)
PART	D.1.1 ARCHITECTURAL BUILDING SOLUTION		DATE	20.5.2025
DRAWING TITLE:			PROJ. PHASE	DPS
UNDERGROUND FLOOR PLAN			SCALE	DRAWING NO.
			1:50	D.1.1-01